

HANECO LED DOWNLIGHT INSTALLATION GUIDE

CEDAR

Thanks for choosing our **CEDAR** Downlight products.
We strongly recommend that you read this manual carefully before installation.

Product Code: CEDAR-RND-TRI



WARNING

- Installation must be carried out by a licenced electrician and in accordance with these instructions and relevant Australian standards and local regulations.
- Do not install any luminaire near any heat source.
- Before the installation make sure you have turned OFF the electricity supply.
- Ensure the product is connected to a 220-240V AC 50/60Hz power supply.
- Non-user replaceable light source.
- The lens cover of the luminaire is secured by glue, unremovable.
- The warranty is void if product is not installed according to the instructions.
- Risk of overheating or fire if the clearance distances to flammable objects are compromised.

Clearance Guide

This range of Haneco Lighting LED products have been tested to AS/NZS60598.2.2:2016 standards and are approved to the luminaire will not exceed 90°C.

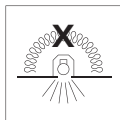

- Suitable for residential or commercial use in AU. Fitting cannot be covered with building insulation.
- Insulation must be placed as per clearance distances according to manufactures installation guide.

Do Not Cover

INFO & WARNING	Do Not Cover
The minimum clearance distance from the top of the luminaire to any normally flammable building element (mm) ...	20 mm
The minimum clearance distance from the top of the luminaire to any building insulation (mm)	10 mm
The minimum clearance distance from the side of the luminaire to any normally flammable building element (mm) .	15 mm
The minimum clearance distance from the side of the luminaire to any normally building insulation (mm)	20 mm

***Building insulation used to abut and cover the luminaire must meet the following requirements:**

- Be of a type that can maintain it's dimensions and structural integrity when exposed to the maximum surface temperatures of the class of luminaire, being 90°C and must withstand a 30s needle flame test carried out in accordance with AS/NZS 60695.11.5 with the flame applied to all surfaces of the sample.
- [New Zealand Only] Loose fill insulation as defined in NZS4246 is not permitted to abut or cover this luminaire.

Product Specification:

Product Code	Supply Voltage	Cutout	Adjustable Angle	Dimming Method	IC Rating	IP Rating	Operating Temp
CEDAR-RND-TRI	220- 240Vac, 50/60Hz	180mm	0-38°	Non-Dimmable	Do Not Cover	IP20	-20°C - 45°C

Installation Instructions

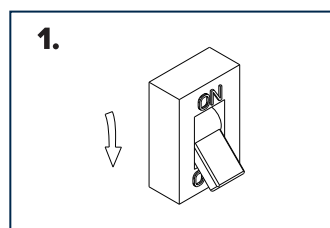

Switch OFF the power.

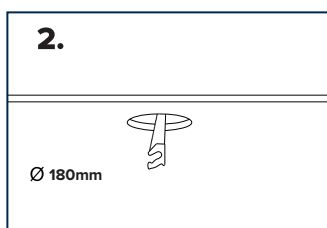

Cut an appropriately sized hole in the ceiling that suits your needs.

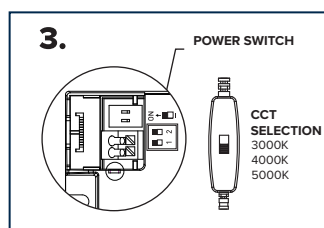

Select CCT and unscrew the case on driver to switch power*.

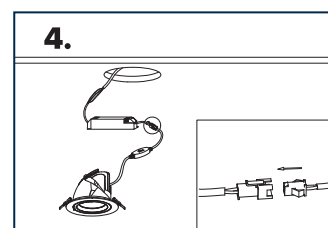

Insert cables through the cut-out into the ceiling cavity and plug into a pre-wired socket outlet inside the ceiling.

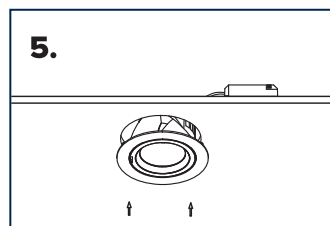

Fold mounting clips up to the sides of the luminaire and insert luminaire through the cut-out.

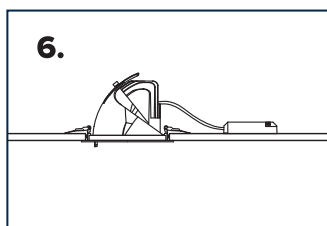

Ensure insulation does not abut and cover the luminaire*.

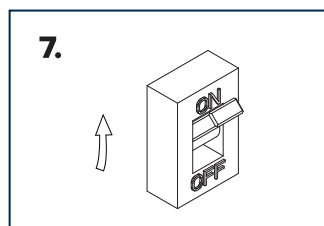

Switch ON power.

*Please check the table to set up output power.

1	2	Iout(mA)	Pout(W)	Iout(V)
-	-	650	26	
ON	-	750	30	30-42
-	ON	850	34	
ON	ON	930	38	30-40